

**SKETCH OF PROPERTY FOR:
THE CITY OF CARRABELLE**

- N O T E S:**
1. SOURCE: Record plat and special instructions per client.
 2. BEARING REFERENCE: Northernly right-of-way boundary of Avenue "B" North having an assumed bearing of West
 3. A current field survey has not been performed to verify the accuracy of the sketch shown hereon.
 4. THIS IS NOT A BOUNDARY SURVEY.
 5. Not valid without the signature and the original raised seal of a Florida licensed surveyor and mapper.

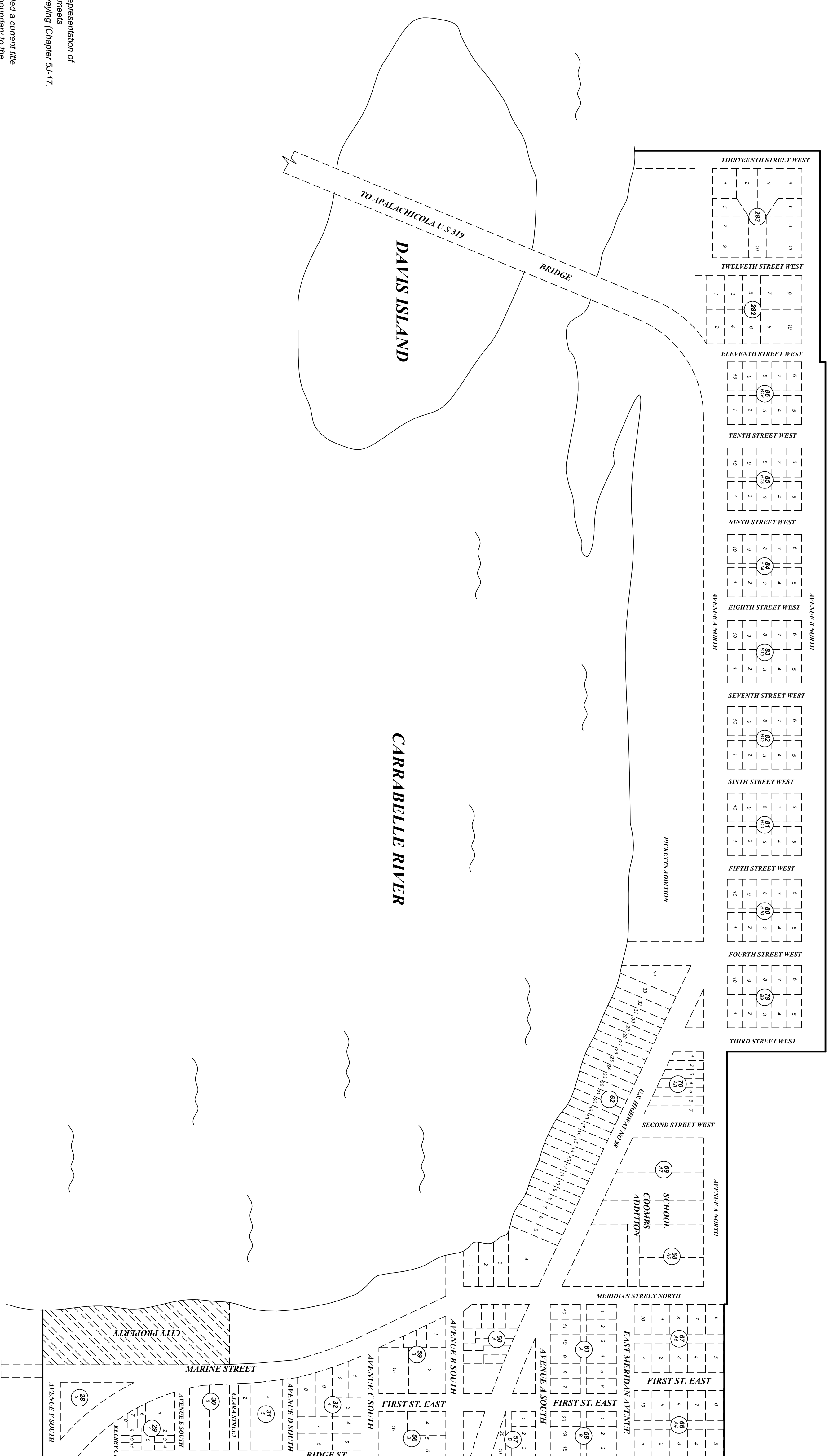

I hereby certify that this is a true and correct representation of the sketch shown hereon and that this sketch meets the minimum technical standards for land surveying (Chapter 5A-17, Florida Administrative Code).

The undersigned surveyor has not been provided a current title opinion or abstract of matters affecting title or boundary to the subject property. It is possible there are deeds of records, unrecorded deeds, easements or other instruments which could affect the boundaries.

JAMES T. RODDENBERRY
Surveyor and Mapper
Florida Certificate No. 4261

NO.	DESCRIPTION	DATE
1	CONTRACT AGREEMENT	02/24/14
2	CONTRACT AGREEMENT	02/24/14
3	CONTRACT AGREEMENT	02/24/14
4	CONTRACT AGREEMENT	02/24/14
5	CONTRACT AGREEMENT	02/24/14
6	CONTRACT AGREEMENT	02/24/14
7	CONTRACT AGREEMENT	02/24/14
8	CONTRACT AGREEMENT	02/24/14
9	CONTRACT AGREEMENT	02/24/14
10	CONTRACT AGREEMENT	02/24/14
11	CONTRACT AGREEMENT	02/24/14
12	CONTRACT AGREEMENT	02/24/14
13	CONTRACT AGREEMENT	02/24/14
14	CONTRACT AGREEMENT	02/24/14
15	CONTRACT AGREEMENT	02/24/14
16	CONTRACT AGREEMENT	02/24/14
17	CONTRACT AGREEMENT	02/24/14
18	CONTRACT AGREEMENT	02/24/14
19	CONTRACT AGREEMENT	02/24/14
20	CONTRACT AGREEMENT	02/24/14

DATE:	02/24/14
DATE OF LAST FIELD WORK:	
FIELD BOOK PAGE:	
COUNTY:	FRANKLIN
DRAWING NAME:	14060.DWG
DRAWN BY:	MMD

CLIENT:
CITY OF CARRABELLE

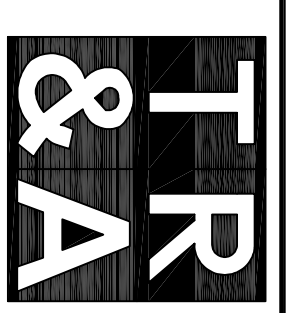

THURMAN RODDENBERRY & ASSOCIATES, INC.
PROFESSIONAL SURVEYORS AND MAPPERS
P.O. BOX 100 • 125 SHELDON STREET • SOPCHOPPY, FLORIDA 32338
PHONE NUMBER: 850-962-2538 FAX NUMBER: 850-962-1103
L# # 7160

JOB NO.	14-060
SHEET NO.	1 OF 1

